



**Product Catalogue  
Prosthetic & Orthotic Components**



**Live True Life...**

*Ideas Shaped, Quality Delivered*



## About Us....

Trushape Precision Castings Pvt. Ltd., established in the year 2000 in Bhavnagar district of Gujarat State of India, manufacturing Ferrous & Non-ferrous Investment Precision Castings by LOST WAX process has carved a niche for itself as the manufacturer of quality Investment Castings. Trushape draws its name from a combination of two words; "True" and "Shape". The name itself embodies the principle, culture and objectives of the company.

Trushape is spread over a sprawling area of 90000 Square Feet with an eye towards ease of future expansion. The manufacturing facility is housed in a modern and spacious building admeasuring 17000 Square Feet. The manufacturing facility is most modern and designed to produce state of the art castings, conforming to most international standards as well as product specific standards

Trushape do not end with making Investment Castings for engineering field applications, it is today also known for manufacturing & supplying Castings for Rehabilitation Aids – Lower Limb Orthotic (Calipers) and Lower Limb Prosthetics (Artificial legs). Intending further to develop the product range for Upper limb prosthetics (Artificial-hands)

True objective of Trushape is to develop and make available import substitute & cost effective wide range of rehabilitation assist aids for physically challenged persons who need them the most.

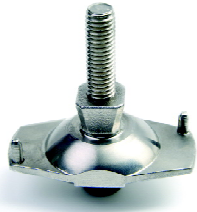

**SACH Foot Adapter**

Article No : PS 301S  
 Material : Stainless Steel  
 Product Weight : 112g.  
 Weight Limit : 100 Kg.



**Tube Adapter**

Article No : PS 302S  
 Material : Stainless Steel  
 Product Weight : 97g.  
 Weight Limit : 100 Kg.



**Tube Clamp Adapter**

Article No : PS 303S  
 Material : Stainless Steel  
 Product Weight : 117g.  
 Weight Limit : 100 Kg.



**Tube Clamp Adapter with Pyramid Top**

Article No : PS 304S  
 Material : Stainless Steel  
 Product Weight : 113g.  
 Weight Limit : 100 Kg.

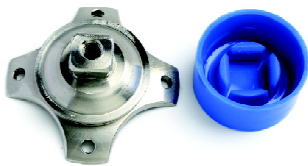

**Four Prong Socket Adapter**

Article No : PS 305S  
 Material : Stainless Steel  
 Product Weight : 115g.  
 Weight Limit : 100 Kg.



**Three Prong Socket Adapter with Rotatable Receiver**

Article No : PS 306S  
 Material : Stainless Steel  
 Product Weight : 177g.  
 Weight Limit : 100 Kg.



**Three Prong Socket Adapter with Rotatable Pyramid**

Article No : PS 307S  
 Material : Stainless Steel  
 Product Weight : 184g.  
 Weight Limit : 100 Kg.



**Square Socket Adapter with Rotatable Receiver**

Article No : PS 308S  
 Material : Stainless Steel  
 Product Weight : 207g.  
 Weight Limit : 100 Kg.

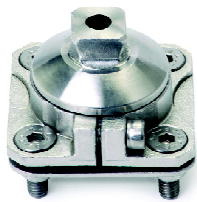

**Square Socket Adapter with Rotatable Pyramid**

Article No : PS 309S  
 Material : Stainless Steel  
 Product Weight : 203g.  
 Weight Limit : 100 Kg.

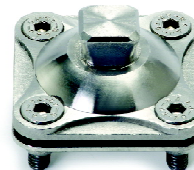

**Pyramid Top Socket Adapter**

Article No : PS 310S  
 Material : Stainless Steel  
 Product Weight : 155g.  
 Weight Limit : 100 Kg.



**Pyramid Receiver Socket Adapter**

Article No : PS 311S  
 Material : Stainless Steel  
 Product Weight : 210g.  
 Weight Limit : 100 Kg.



**Bk Pyramid Top Socket Adapter**

Article No : PS 312S  
 Material : Stainless Steel  
 Product Weight : 196g.  
 Weight Limit : 100 Kg.



**SLIDING TUBE CLAMP ADAPTER**

Article No : PS 313S  
 Material : Stainless Steel  
 Product Weight : 279g.  
 Weight Limit : 100 Kg.



**SLIDING DOUBLE ADAPTER**

Article No : PS 314S  
 Material : Stainless Steel  
 Product Weight : 315g.  
 Weight Limit : 100 Kg.



**Angled Tube Clamp Adapter**

Article No : PS 315S  
 Material : Stainless Steel  
 Product Weight : 125g.  
 Weight Limit : 100 Kg.



**Round Adjustable Adapter**

Article No : PS 316S  
 Material : Stainless Steel  
 Product Weight : 107 g.  
 Weight Limit : 100 Kg.



**Round Pyramid Receiver Socket Adapter**

Article No : PS 317S  
 Material : Stainless Steel  
 Product Weight : 170g.  
 Weight Limit : 100 Kg.

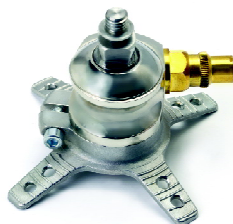

**Shuttle Lock With Socket Adapter**

Article No : PS 318S  
 Material : Stainless Steel  
 Product Weight : 280g.  
 Weight Limit : 100 Kg.

**Double Male - Female Adapter**

Article No : PS 319S-S  
 : PS 319S-M  
 : PS 319S-L  
 Material : Stainless Steel  
 : 130g./ 40mm  
 Product Weight : 167g./ 60mm  
 / Length : 190g./ 75mm  
 Weight Limit : 100 Kg.



**Double Female Adapter**

Article No : PS 320S-S  
 : PS 320S-M  
 : PS 320S-L  
 Material : Stainless Steel  
 : 125g./ 40mm  
 Product Weight : 160g./ 60mm  
 / Length : 190g./ 75mm  
 Weight Limit : 100 Kg.



**Pyramid Adapter**

Article No : PS 321S  
 Material : Stainless Steel  
 Product Weight : 84g.  
 Weight Limit : 100 Kg.

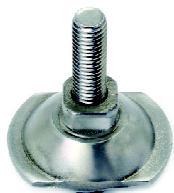

**Socket Adapter Plastic Base**

Article No : PS 322P  
 Material : Plastic  
 Product Weight : 90g.  
 Weight Limit : 100 Kg.



**Pyramid Receiver with Plastic Base**

Article No : PS 323PS  
 Material : Plastic & Stainless Steel  
 Product Weight : 195g.  
 Weight Limit : 100 Kg.



**Pyramid Top with Plastic Base**

Article No : PS 324PS  
 Material : Plastic & Stainless Steel  
 Product Weight : 174g.  
 Weight Limit : 100 Kg.







**Below Knee Prosthetic Kit - REG (Regular)**

Article No : BK 501  
 Material : Stainless Steel Adapters / Aluminium Tube / PU Foot  
 Product Weight : 570 g (without SACH Foot)  
 Weight Limit : 100 Kg

**BK 501 - Below Knee Prosthetic Kit Contents :**

1. SACH Foot Adapter, Article No. PS 301S
2. Four Prong Socket Adapter, Article No. PS 305S
3. Tube Clamp Adapter, Article No. PS 303S
4. Short Pylon with integrated Tube Adapter, Article No. SP30225AS
5. SACH Foot (Optional)



**Below Knee Prosthetic Kit - PRS (Pyramid Receiver Socket)**

Article No : BK 502  
 Material : Stainless Steel Adapters / Aluminium Tube / PU Foot  
 Product Weight : 660 g (without SACH Foot)  
 Weight Limit : 100 Kg

**BK 502 - Below Knee Prosthetic Kit Contents :**

1. SACH Foot Adapter, Article No. PS 301S
2. Pyramid Receiver Socket Adapter, Article No. PS 311S
3. Tube Clamp with Pyramid Top Adapter, Article No. PS 303S
4. Short Pylon with integrated Tube Adapter, Article No. SP30225AS
5. SACH Foot (Optional)



**Below Knee Prosthetic Kit - PTS (Pyramid Top Socket)**

Article No : BK 503  
 Material : Stainless Steel Adapters / Aluminum Tube / PU Foot  
 Product Weight : 650 g (without SACH Foot)  
 Weight Limit : 100 Kg

**BK 503 - Below Knee Prosthetic Kit Contents :**

1. SACH Foot Adapter, Article No. PS 301S
2. Pyramid Top Socket Adapter, Article No. PS 312S
3. Tube Clamp Pyramid Receiver Adapter, Article No. PS 303S
4. Short Pylon with integrated Tube Adapter, Article No. SP30225AS
5. SACH Foot (Optional)



**Product : AK 551 - Single Axis Knee Joint**

Article No : AK 551  
 Material : Stainless Steel Adapters / Aluminium Tube / PU Foot  
 Flexion : Knee Flexion angle aprox. 150°  
 Product Weight : 1.400 Kg (without SACH Foot)  
 Weight Limit : 100 Kg

**AK 551 - Above Knee Prosthetic Kit Contents :**

1. SACH Foot Adapter, Article No. PS 301S
2. Tube Clamp Adapter, Article No. PS 303S
3. Long Pylon with integrated Tube Adapter, Article No. LP 30400AS
4. Three Prong Socket Adapter with Rotatable Receiver, Article No. PS 306S
5. Single Axis Knee Joint With Weight Activated Brake, Article No. PK 651S
6. SACH Foot (Optional)

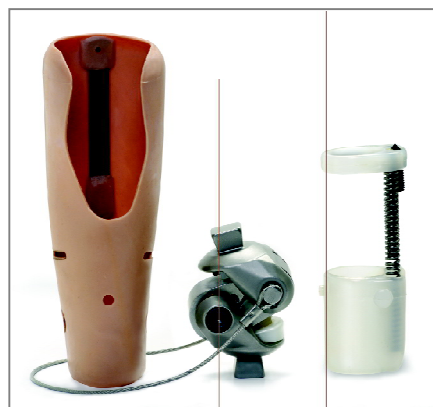

**Product : AK 552 - 4 Bar Polycentric Knee Joint**

Article No : AK 552  
 Material : Stainless Steel Adapters / Aluminium Tube / PU Foot  
 Flexion : Knee Flexion angle aprox. 120°  
 Product Weight : 1.395 Kg (without SACH Foot)  
 Weight Limit : 100 Kg

**AK 552 - Above Knee Prosthetic Kit Contents :**

1. SACH Foot Adapter, Article No. PS 301S
2. Tube Clamp Adapter, Article No. PS 303S
3. Long Pylon with integrated Tube Adapter, Article No. LP 30400AS
4. Three Prong Socket Adapter with Rotatable Receiver, Article No. PS 306S
5. 4 Bar Polycentric Knee Joint, Article No. PK 652S
6. SACH Foot (Optional)

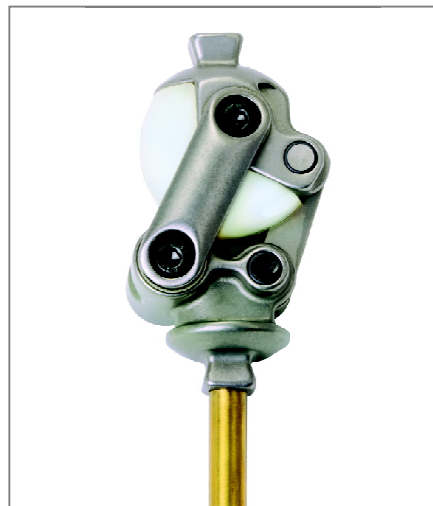



**Product : AK 553 - 4 Bar Polycentric Knee Joint**

Article No : AK 553  
 Material : Stainless Steel Adapters / Aluminium Tube / PU Foot  
 Flexion : Knee Flexion angle aprox. 120°  
 Product Weight : 1.290 Kg (without SACH Foot)  
 Weight Limit : 100 Kg

**AK 553 - Above Knee Prosthetic Kit Contents :**

1. SACH Foot Adapter, Article No. PS 301S
2. Three Prong Socket Adapter with Rotatable Receiver, Article No. PS 306S
3. Long Pylon with integrated Tube Adapter, Article No. LP 30400AS
4. Four Bar Polycentric Knee Joint with integrated Tube Adapter, Article No. PK 653S
5. SACH Foot (Optional)



**Product : AK 554 - Low Weight Four Bar Polycentric Knee Joint**

Article No : AK 554  
 Material : Stainless Steel Adapters / Aluminium Tube / PU Foot  
 Flexion : Knee Flexion angle aprox. 165°  
 Product Weight : 1.200 Kg (without SACH Foot)  
 Weight Limit : 100 Kg

**AK 554 - Above Knee Prosthetic Kit Contents :**

1. SACH Foot Adapter, Article No. PS 301S
2. Long Pylon with integrated Tube Adapter, Article No. LP 30400AS
3. Three Prong Socket Adapter with Rotatable Receiver, Article No. PS 306S
4. Low Weight 4 Bar Polycentric Knee Joint, Article No. PK 654AS
5. SACH Foot (Optional)





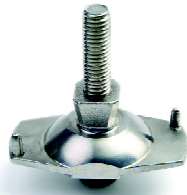

**SACH Foot Adapter**

Article No : PS 701S  
 Material : Stainless Steel  
 Product Weight : 70 g.  
 Weight Limit : 45 Kg.



**Tube Adapter**

Article No : PS 702S  
 Material : Stainless Steel  
 Product Weight : 49 g.  
 Weight Limit : 45 Kg.



**Tube Clamp Adapter**

Article No : PS 703S  
 Material : Stainless Steel  
 Product Weight : 54 g.  
 Weight Limit : 45 Kg.



**Four Prong Socket Adapter**

Article No : PS 704S  
 Material : Stainless Steel  
 Product Weight : 62 g.  
 Weight Limit : 45 Kg.



**Three Prong Socket Adapter with Rotatable Receiver**

Article No : PS 705S  
 Material : Stainless Steel  
 Product Weight : 128 g.  
 Weight Limit : 45 Kg.

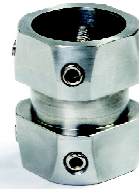

**Double Female Adapter**

Article No : PS 706S  
 Material : Stainless Steel  
 Product Weight : 103 g.  
 Weight Limit : 45 Kg.

**Transtibial Prosthetic Kit**

Article No : BK 775  
 Material : Stainless Steel / PU Foot  
 Product Weight : 380 g. (Without SACH Foot)  
 Weight Limit : 60 Kg.

**BKP KIT 01A - Transtibial Prosthetic Kit Contents :**

1. SACH Foot Adapter, Article No. PS 701S
2. Tube Clamp Adapter, Article No. PS 703S
3. Four Prong Socket Adapter, Article No. PS 704A
4. Short Pylon with integrated Tube Adapter, Article No. SP 19200AS
5. SACH Foot (Optional)



**Trans Femoral Prosthetic Kit**

Article No : BK 785  
 Material : S Steel / Aluminium / PU Foot  
 Product Weight : 575 g. (Without SACH Foot)  
 Weight Limit : 60 Kg.

**AKP KIT 01A - Trans Femoral Prosthetic Kit Contents :**

1. SACH Foot Adapter, Article No. PS 701S
2. Four Bar Knee Joint - Aluminium, Article No. PK 686A
3. Long Pylon with integrated Tube Adapter, Article No. LP 25310AS
4. Three Prong Socket Adapter with Rotatable receiver, Article No. PS 705S
5. SACH Foot (Optional)





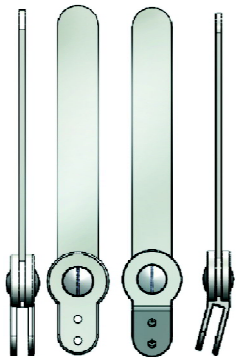

**Ankle Joint**

Size	Article No.	Weight Kg.
I - Small	AJ 001S-S	107 g.
II - Medium	AJ 001 S-M	167 g.
III- Large	AJ 001S-L	138 g.

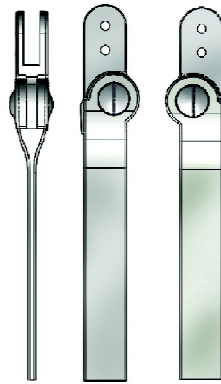

**Hip Joint**

Size	Article No.	Weight Kg.
I - Small	HJ 002S-S	195 g.
II - Medium	HJ 002S-M	290 g.
III- Large	HJ 002S-L	368 g.

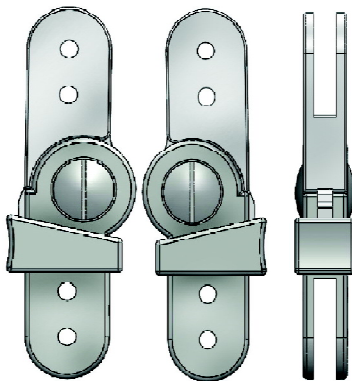
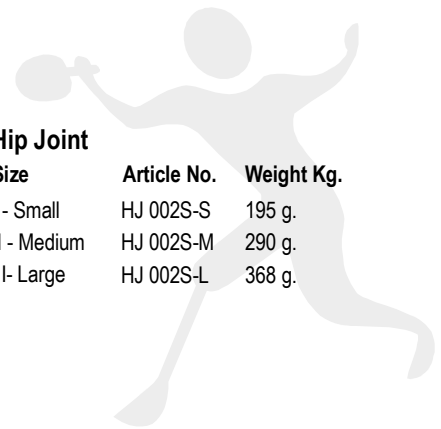

**Knee Joint (Drop Lock)**

Size	Article No.	Weight Kg.
I - Small	KJ 004S-S	145 g.
II - Medium	KJ 004S-M	208 g.
III- Large	KJ 004S-L	263 g.

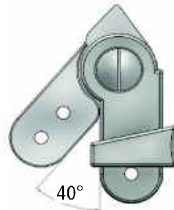

**Knee Joint (Complete with Uprights)**

Size	Article No.	Bar Length	Weight Kg.
I - Small	KJ 004SA-S	10"	300 g.
II - Medium	KJ 004SA-M	12"	530 g.
III- Large	KJ 004SA-L	14"	710 g.

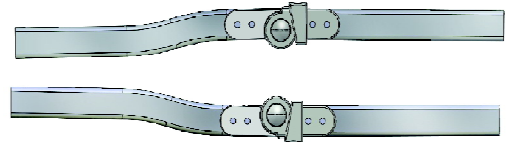

**Joint Bars / Uprights (Aluminium)**

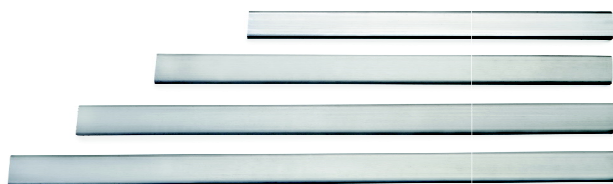

**Available Sizes**

Size I (W12 X H5 MM)		
Length	Article No.	Weight G.
10"	JB S/C 10A-S	36.0 g.
12"	JB S/C 12A-S	43.2 g.
14"	JB S/C 14A-S	50.4 g.
20"	JB S/C 20A-S	81.0 g.
60"	JB S/C 60A-S	216 g.

Size II (W16 X H6 MM)		
Length	Article No.	Weight G.
10"	JB S/C 10A-M	67.0 g.
12"	JB S/C 12A-M	80.0 g.
14"	JB S/C 14A-M	93.8 g.
23.5"	JB S/C 23.5A-M	157.5 g.
60"	JB S/C 60A-M	402 g.

Size III (W20 X H6 MM)		
Length	Article No.	Weight G.
10"	JB S/C 10A-L	78.0 g.
12"	JB S/C 12A-L	93.6 g.
14"	JB S/C 14A-L	109.2 g.
15.5"	JB S/C 15.5A-L	120.9 g.
60"	JB S/C 60A-L	406.0 g.

Note: All sizes of joint bars can be made available in Straight & Contour shape and joint bars of size 20" and 23.5" length can be made available with contour shape at both the end of bar.

**Polycentric Joint**

Article No.: PJ 005S  
Weight, per pair : 334 g.

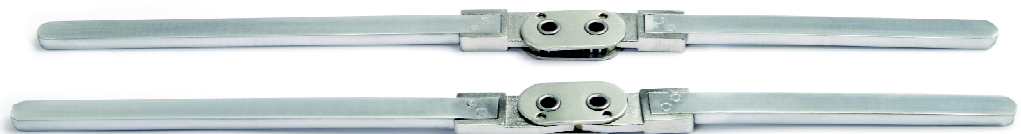

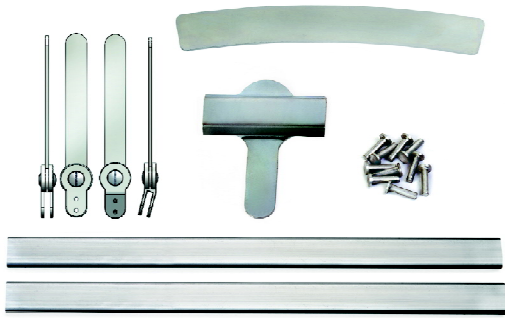

**A F O (Ankle Foot Orthosis)**

**AFO Kit contents :**

- Calf Band, Size I, II, III, Article No. CB 251M -S/M/L
- Ankle Joint (Set Left & Right), Size I, II, III, Article No. AJ 001S -S/M/L
- Stirrup Split (Pair), Size I, II, III, Article No. SS 255M -S/M/L
- Stirrup Plate, Size I, II, III, Article No. SP 256M -S/M/L
- **Joint Bar :**
- Size I (2 Nos. Straight X 10"), Article No. JBS 10A-S
- Size II (2 Nos. Straight X 12"), Article No. JBS 12A-M
- Size III (2 Nos. Straight X 12"), Article No. JBS 12A-L
- Aluminum Rivets - 10 Nos., Article No. RVT 901A

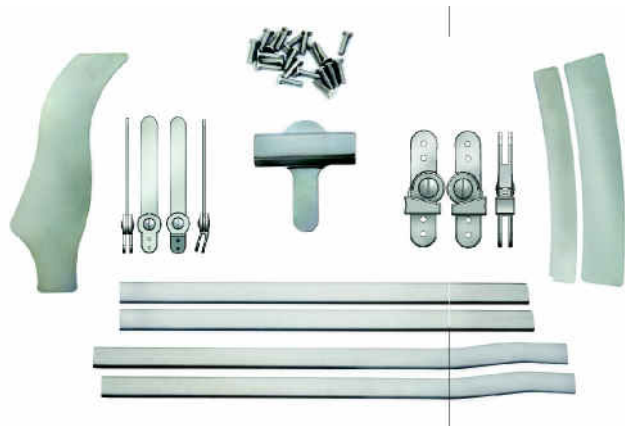

**K A F O (Knee Ankle Foot Orthosis)**

**KAFO Kit contents :**

- Calf Band, Size I, II, III, Article No. CB 251M -S/M/L
- Ankle Joint (Set Left & Right), Size I, II, III, Article No. AJ 001S -S/M/L
- Thigh Band, Size I, II, III, Article No. THB 252M -S/M/L
- Knee Joint (Set Left & Right), Size I, II, III, Article No. KJ 004S -S/M/L
- Tuber Band, Size I, II, III, Article No. TB 253M -S/M/L
- Stirrup Split (Pair), Size I, II, III, Article No. SS 255M -S/M/L
- Stirrup Plate, Size I, II, III, Article No. SP 256M -S/M/L
- **Joint Bar :**
- Size I (2 Nos. Straight X 10" & 2 Nos. of Contour X 10"), Article No. JBS/C 10A-S
- Size II (2 Nos. Straight X 12" & 2 Nos. of Contour X 14"), Article No. JBS 12A-M / JBC 14A-M
- Size III (2 Nos. Straight X 12" & 2 Nos. of Contour X 16"), Article No. JBS 12A-L / JBC 16A-L
- Aluminum Rivets - 20 Nos., Article No. RVT 901A

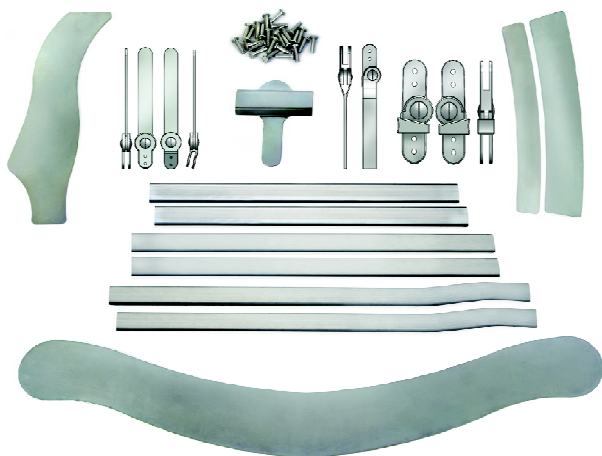

**H K A F O (Hip Knee Ankle Foot Orthosis)**

**HKAFO Kit contents :**

- Calf Band, Size I, II, III, Article No. CB 251M -S/M/L
- Ankle Joint (Set Left & Right), Size I, II, III, Article No. AJ 001S -S/M/L
- Thigh Band, Size I, II, III, Article No. THB 252M -S/M/L
- Knee Joint (Set Left & Right), Size I, II, III, Article No. KJ 004S -S/M/L
- Tuber Band, Size I, II, III, Article No. TB 253M -S/M/L
- Hip Joint (Left or Right), Size I, II, III, Article No. HJ 005S -S/M/L
- Pelvic Band, Size I, II, III, Article No. PB 254M -S/M/L
- Stirrup Split (Pair), Size I, II, III, Article No. SS 255M -S/M/L
- Stirrup Plate, Size I, II, III, Article No. SP 256M -S/M/L
- **Joint Bar :**
- Size I (4 Nos. Straight X 10" & 2 Nos. of Contour X 10"), Article No. JBS/C 10A-S
- Size II (4 Nos. Straight X 12" & 2 Nos. of Contour X 16"), Article No. JBS 12A-M / JBC 14A-M
- Size III (2 Nos. Straight X 12", 2 Nos. of Contour X 14" & 2 Nos. of Contour X 16"), Article No. JBS 12A-L / JBC 14AL / JBC 16A-L
- Aluminum Rivets - 30 Nos., Article No. RVT 901A

Calf Band	Size	Article No.	Weight G.
	L55XW25XH1.25 MM	CB 251M - S	36 g.
	L70XW30XH1.25 MM	CB 251M - M	47 g.
	L210XW30XH1.6 MM	CB 251M - L	72 g.
Tuber Band	L170XW48XH1.25 MM	TB 253M - S	55 g.
	L215XW53XH1.25 MM	TB 253M - M	83 g.
	L260XW65XH1.6 MM	TB 253M - L	153 g.
	L305XW85XH1.6 MM	TB 253M - X	212 g.
	L355XW110XH1.6 MM	TB 253M - XX	259 g.
Stirrup Split	L107.5XW12XH3 MM	SS 255M - S	30 g.
	L129XW16XH3 MM	SS 255M - M	48 g.
	L150XW20XH3 MM	SS 255M - L	72 g.

Thigh Band	Size	Article No.	Weight G.
	L605XW40XH1.25 MM	TB 252M - S	58 g.
	L85XW45XH1.25 MM	TB 252M - M	76 g.
	L230XW50XH1.6 MM	TB 252M - L	128 g.
Pelvic Band	L360XW65XH1.25 MM	PB 254M - S	112 g.
	L480XW89XH1.25 MM	PB 254M - M	216 g.
	L560XW122XH1.6 MM	PB 254M - L	392 g.
Stirrup Plate	L75XW60XH2 MM	SP 256M - S	53 g.
	L90XW70XH2 MM	SP 256M - M	76 g.
	L115XW80XH2MM	SP 256M - L	94 g.





Negroid Colour Foot with Toes is also available.

**Available Sizes :**

**For Children with Toes**

Size / CM	Article No.	Weight G.	Weight Limit
15 L / R	SF 15	145 g.	35 Kg.
16 L / R	SF 16	160g.	35 Kg.
17 L / R	SF 17	175 g.	35 Kg.
18 L / R	SF 18	195 g.	45 Kg.
19 L / R	SF 19	215 g.	45 Kg.

**For Adults with Toes**

Size / CM	Article No.	Weight G.	Weight Limit
20 L / R	SF 20	290 g.	90 Kg.
21 L / R	SF 21	310 g.	90 Kg.
22 L / R	SF 22	330 g.	95 Kg.
23 L / R	SF 23	350 g.	95 Kg.
24 L / R	SF 24	470 g.	95 Kg.
25 L / R	SF 25	490 g.	100 Kg.
26 L / R	SF 26	510 g.	100 Kg.
27 L / R	SF 27	530 g.	100 Kg.



**Available Sizes :**

**For Children with integrated Tube Adapter**

Size	Article No.	Weight G.	Weight Limit
D22XL160MM	SP 22160AS		45 Kg.
D22XL200MM	SP 22200AS		45 Kg.
D22XL310MM	LP 22310AS		45 Kg.

**For Adults with integrated Tube Adapter**

Size	Article No.	Weight G.	Weight Limit
D30XL200MM	SP 30200AS		100 Kg.
D30XL225MM	SP 30225AS		100 Kg.
D30XL300MM	SP 30300AS		100 Kg.
D30XL400MM	LP 30400AS		100 Kg.

Note : The information, specification, claims and photographs in this Catalogue are only indicative and for tentative reference, and are not a legal offering & are subject to change at sole discretion of Trushape Management without any prior notice.



*Ideas Shaped, Quality Delivered*



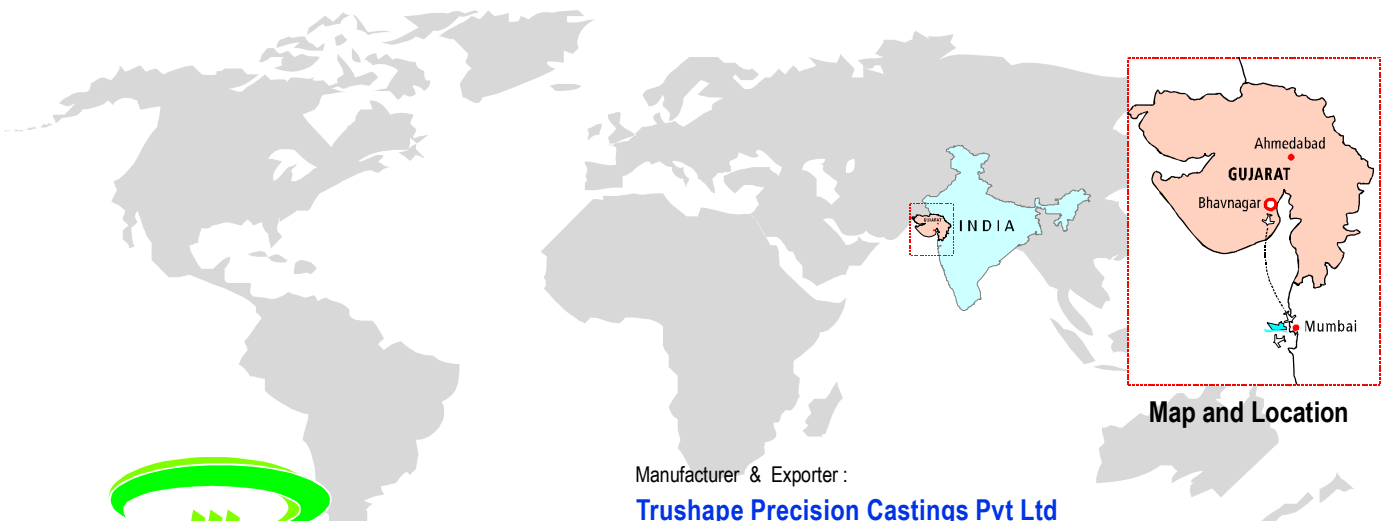
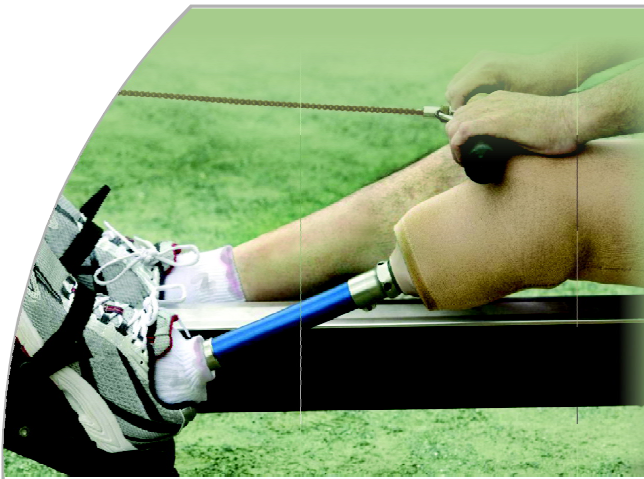

Map and Location



Manufacturer & Exporter :

**Trushape Precision Castings Pvt Ltd**

■ Survey No. 160, Bhavnagar-Rajkot Road, Village : Shampara  
Dist.: Bhavnagar, Gujarat-364060, INDIA

■ Tel : +91 278 2541097 / 99  
■ Fax : +91 278 2541098

■ E-mail : [contact@tpclcastings.com](mailto:contact@tpclcastings.com)  
■ Web : [www.tpclcastings.com](http://www.tpclcastings.com)